





OKI - Congestion Mitigation and Air Quality Federal Funding EV Cincy Week October 1, 2020



www.oki.org

 [/okiregional](https://www.facebook.com/okiregional)

 [/okircog](https://twitter.com/okircog)

Federal Funding

- FAST Act
 - Fixing America's Surface Transportation Act
 - Authorizes \$305 billion over FY 2016 through FY 2020
 - Extended 1 year
 - Most funding comes from Highway Trust Fund
 - Apportioned to states

FAST Act – Highway Programs

- Surface Transportation Block Grant Program
- Highway Safety Improvement Program
- Congestion Mitigation and Air Quality Improvement (CMAQ) Program
- Transportation Alternatives
- National Highway Performance Program
- All programs require minimum 20% State/Local match
- Some programs have required sub-allocation to urban areas

Ohio Overview

- Ohio apportionment includes required and discretionary amounts suballocated to Urban Areas (MPOs)
 - Surface Transportation Block Grant Program (STBG)
 - Congestion Mitigation and Air Quality (CMAQ)
 - Transportation Alternatives Program (TA)
- 17 MPOs
- 5 “large” cities

OKI Annual Allocation for Transportation Projects

- Ohio
 - STBG, \$25m
 - TA, \$2.6m
 - CMAQ, OHIO Statewide \$61m (~\$12m OKI)
- Kentucky
 - STBG, \$7.5m
 - TA, 450k
- Indiana
 - STBG, 206k
 - CMAQ, 64k
 - HSIP, 50k
 - TA, 17k

CMAQ

- \$81 million available 15 of 17 MPOs eligible
 - Air quality nonattainment, maintenance or former nonattainment areas
- 8 large MPOs are grouped into single statewide urban program
- Projects must result in mobile source emission reductions
 - Traffic flow such as turn lanes, roundabouts, traffic signals and intersection improvements
 - Diesel engine retrofits, advanced truck technologies
 - Freight and intermodal projects
 - Transit capital and new service operations
 - Bicycle/pedestrian improvements
 - Carpooling and vanpooling
 - Alternative fuel vehicles

CMAQ and Electric Vehicles

- EV charging is eligible if publicly owned or leased
- Private EV charging must be reasonably accessible to the public
- CMAQ funds may be used for publicly-owned EV vehicles (i.e. replacement of diesel buses with electric buses)
- Must demonstrate quantifiable emission benefits

OKI FY21-24 TIP CMAQ Projects

- 6 bicycle/pedestrian
- 6 bus replacement
- 5 roundabouts
- 5 turn lanes
- 2 multi-modal facilities
- 3 signalization

2021 OKI Prioritization Process

- Applications available March 2021
- Applications due June 2021
- Project selection October 2021
- Funds available for FY25
- Ohio STBG/CMAQ and TA sub-allocated funds
- Kentucky STBG/TA sub-allocated funds



Enhanced Mobility for Seniors and Individuals with Disabilities

5310 Funding Program

- 112 Active OKI funded vehicles (operated by 20 agencies)
- 35 vehicles (or 31%) are beyond FTA useful life benefit and eligible for replacement.

EV options are currently being explored as replacement funding is considered.





Community Energy Plan

8 Model Plans



HARLAN TOWNSHIP



Technical assistance is available to any OKI community.
 Contact: Andy Meyer ameyer@oki.org

Land Use Mix

Mixed use developments create areas where retail, office, entertainment, and residential uses mix—often sharing the same building. These developments are designed to be walkable and active, encouraging multiple activities and less driving.



Connectivity

Transportation has a big impact on how much energy our community uses. Designing roads that not only accommodate cars, but also pedestrians, bikes, and buses provides options to use more efficient ways of getting around.



Density and Pattern

Residential density near a major route like Colerain Ave, supports the transportation options listed above. Certain street patterns can make walking in a community easier. Cluster developments in more rural areas preserves hillsides and natural areas while minimizing energy hogging lawns.

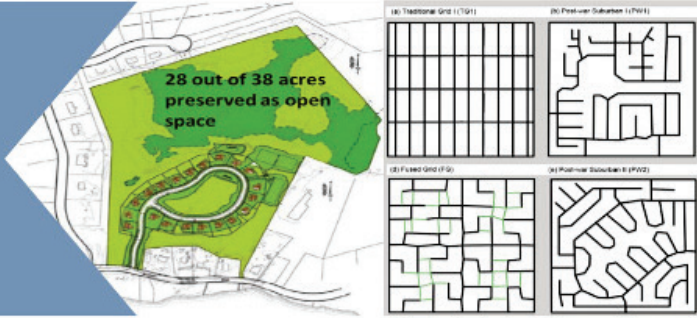

Diversity of Housing

There are a wide variety of jobs available in most communities—professional jobs, office jobs, retail, and service sector jobs that attract workers of all ages and income levels. A diverse range of housing is needed to house these workers and their families. Without diversity in housing, many workers will need to live outside of the community and commute from longer distances.



Contact Info

Andy Reser

OKI Manager of Transportation Programming

areser@oki.org

513-619-7688